

## DETAIL & SUBMITTAL SHEET

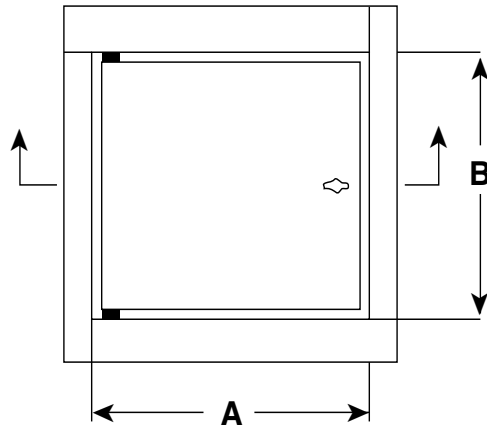

FRONT ELEVATION



**SPECIFICATIONS:**

- Door:** 18 ga. steel
- Frame:** 16 ga. steel, 2 1/2" deep
- Insulation:** 2" thick mineral wool (THERMAFIBER®), in between two pieces of 22 ga. steel
- Hinge:** Fully concealed, pivot rod type hinge. Allows opening to 140°
- Latches:** Knurled knob lock & 1 Flush key
- Automatic Panel Closer:** Furnished on all doors. vertical position only. Ceiling position requires self-assisted closing
- Inside Panel Release:** Furnished on all doors
- Finish:** Grey baked enamel coat
- Ceiling Installation:** To comply with current fire regulations, largest size acceptable is 24" x 36"

**OPTIONS:**

- Finishes:**
- Stainless Steel Type 304 No. 4 Satin Finish Brushed
  - Stainless Steel Type 316 No. 4 Satin Finish Brushed
- Options:**
- Mortise Best Lock
  - Hot Smoke Seal gasketing all 4 sides\* \*
  - Special sizes available

**SECTION DETAIL**

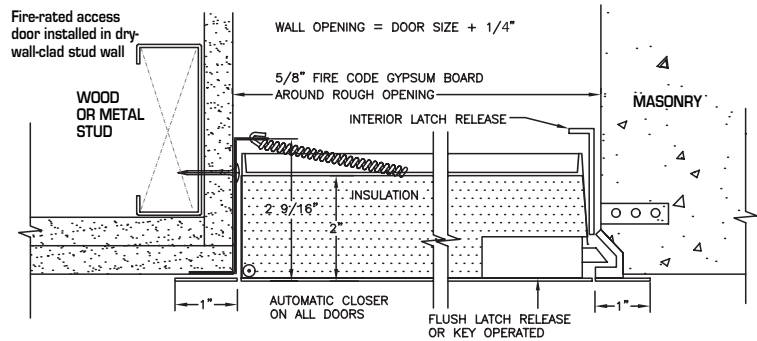

Fire-rated access door installed in three-hour ceiling system

On size 16" x 16" and larger, extra spring supplied with door must be attached from back of door pan to framing or floor above in such a manner to insure that door is self-closing

This fire-rated door can be used wherever it is necessary to provide service access to shafts and any other location which must have a fire rating. Approved for wall and ceiling use.

\*\* Hot Smoke Seal™ fire tested: Listed to meet the requirements of standards UL10B, UL10C, UBC 7-2, Part 1 and BS476: 1987 for application to fire rated door assemblies.



**THERMAFIBER®** Industrial Felt insulation for optimal fire protection (rated noncombustible by NFPA Standard 220 when tested in accordance with ASTM E136 and withstands ASTM E119) and superior sound control USG tested per ASTM C165: 8 pcf STC 15-2" thickness



UL, Northbrook, IL - 1-1/2 hour "B" label 450 degrees F (250 degrees C) maximum temperature rise in 30 minutes for vertical wall installations only. Test file number R-10364. This door may be used in a two hour fire rated wall assembly



Warnock Hersey International; Pittsburgh, CA - 1 hour fire rated combustible floor and ceiling assembly - Report # WHI-495-PSH-0191

Warnock Hersey International; Pittsburgh, CA - 3 hour fire rated non-combustible floor and ceiling assembly - Report # WHI-495-PSH-0192

Item No.	Door Size W x H	Wall Opening	Slam Catch	Ship Wt. Lbs.
FR 800	8 x 8	8 1/4 x 8 1/4	1	8
FR 800	10 x 10	10 1/4 x 10 1/4	1	10
FR 800	12 x 12	12 1/4 x 12 1/4	1	12
FR 800	12 x 18	12 1/4 x 18 1/4	1	16
FR 800	12 x 24	12 1/4 x 24 1/4	1	19
FR 800	14 x 14	14 1/4 x 14 1/4	1	14
FR 800	16 x 16	16 1/4 x 16 1/4	1	17
FR 800	18 x 18	18 1/4 x 18 1/4	1	21
FR 800	18 x 24	18 1/4 x 24 1/4	1	26
FR 800	20 x 20	20 1/4 x 20 1/4	1	24
FR 800	20 x 24	20 1/4 x 24 1/4	2	30
FR 800	20 x 30	20 1/4 x 30 1/4	2	37
FR 800	21 x 36	21 1/4 x 36 1/4	2	43
FR 800	22 x 22	22 1/4 x 22 1/4	1	28
FR 800	22 x 24	22 1/4 x 24 1/4	1	29
FR 800	22 x 30	22 1/4 x 30 1/4	2	39
FR 800	22 x 36	22 1/4 x 36 1/4	2	47
FR 800	24 x 24	24 1/4 x 24 1/4	1	32
FR 800	24 x 30	24 1/4 x 30 1/4	2	43
FR 800	24 x 36	24 1/4 x 36 1/4	2	48
FR 800	24 x 48	24 1/4 x 48 1/4	2	62
FR 800	30 x 30	30 1/4 x 30 1/4	2	50
FR 800	32 x 32	32 1/4 x 32 1/4	2	55
FR 800	36 x 36	36 1/4 x 36 1/4	2	67
FR 800	36 x 48	36 1/4 x 48 1/4	2	88
FR 800	48 x 48	48 1/4 x 48 1/4	2	104

Project: \_\_\_\_\_ Date: \_\_\_\_\_

Contractor: \_\_\_\_\_ Architect: \_\_\_\_\_

Sizes: \_\_\_\_\_ Quantity: \_\_\_\_\_ Approval Initials: \_\_\_\_\_



Corporate Office: 1330 Progress Drive • Front Royal, VA 22630  
Phone: 1-800-255-5515 • Fax: 1-800-822-5001

[www.wbdoors.com](http://www.wbdoors.com)