

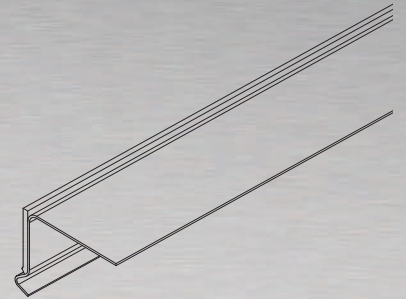

# HEAD OF WALL SYSTEMS



*Solutions for  
Fire-stopping*



*Solutions for  
Deflection*

Slotted Track | CST  
M-Track | CMT

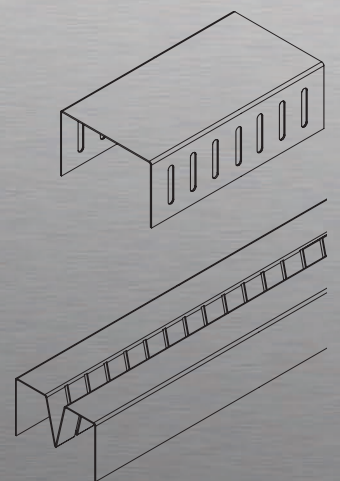

MADE IN AMERICA

# TABLE OF CONTENTS

<i>Head of Wall (HOW) Systems - Overview</i> .....	3
<i>System 1 – Pan Deck</i> .....	4 - 5
<i>System 2 – Flat Concrete Deck</i> .....	6 - 7
<i>System 3 – Pan Deck</i> .....	8 - 9
<i>System 4 – Flat Concrete Deck</i> .....	10 - 11
<i>System 5 – Pan Deck</i> .....	12 - 13
<i>FireStik™ – “CFS” Specification</i> .....	14
<i>FireStik™ – Design Community</i> .....	15
<i>FireStik™ – Contractors</i> .....	16
<i>Slotted Track</i> .....	17
<i>M-Track</i> .....	18

# HEAD OF WALL SYSTEMS

Specify CEMCO HOW PRODUCTS for easy installation and to meet Life-Safety Building Codes. Regardless of whether you design, specify or install you'll appreciate the many benefits that CEMCO HOW PRODUCTS have to offer.

## System 1

Pan-deck with **Slotted/M-Track** using **FireStik** as the fire-stopping with fire proofing spray to fill flutes or mineral wool as an alternate.

## System 2

Flat deck with **Slotted/M-Track** as the track and **FireStik** as the fire-stopping element.

## System 3

Pan-deck with **Slotted/M-Track** using mineral wool in flute and head of wall gap with sprays to hold in place.

## System 4

Flat deck with **Slotted/M-Track** using mineral wool/spray or just caulk in the head of wall gap.

## System 5

Pan-deck with **Slotted/M-Track** utilizing angle mesh and fire-proofing.

## System 6

Pan-deck with **Slotted/M-Track** using drywall ribs and angle for fire-stopping with fire-proofing or mineral wool/spray to fill the flutes.

## System 7

Flat deck with **Slotted/M-Track** using drywall ribs and angle for fire-stopping.

## How They Work Together

Installing **Head of Wall (HOW)** assemblies that meet current codes addressing vertical movement of a building and fire-stop requirements of wall partitions is a challenge. By integrating the **FireStik** with a variety of **HOW products** such as the **Cemco Slotted** or **M-Track**, simple head of wall assemblies can be easily installed providing up to 1" of deflection with **fire-stopping that outperforms the toughest code requirements**. These tested **Cemco** products exceed the latest test standards required in UL 2079, ASTM E-119, and ASTM E-814 and are listed at both **UL** and **Warnock Hersey**. The designs eliminate the reliance upon caulks, sprays, drywall ribs, flute plates, and custom track profiles as well as the mobilization, labor, and material costs required to install them in current assemblies. The **Cemco FireStik** and choice of tracks create **unencumbered and immediate fire-stop assemblies** that experience **no system fatigue** creating superior life safety designs covering low, mid, and high rise buildings.



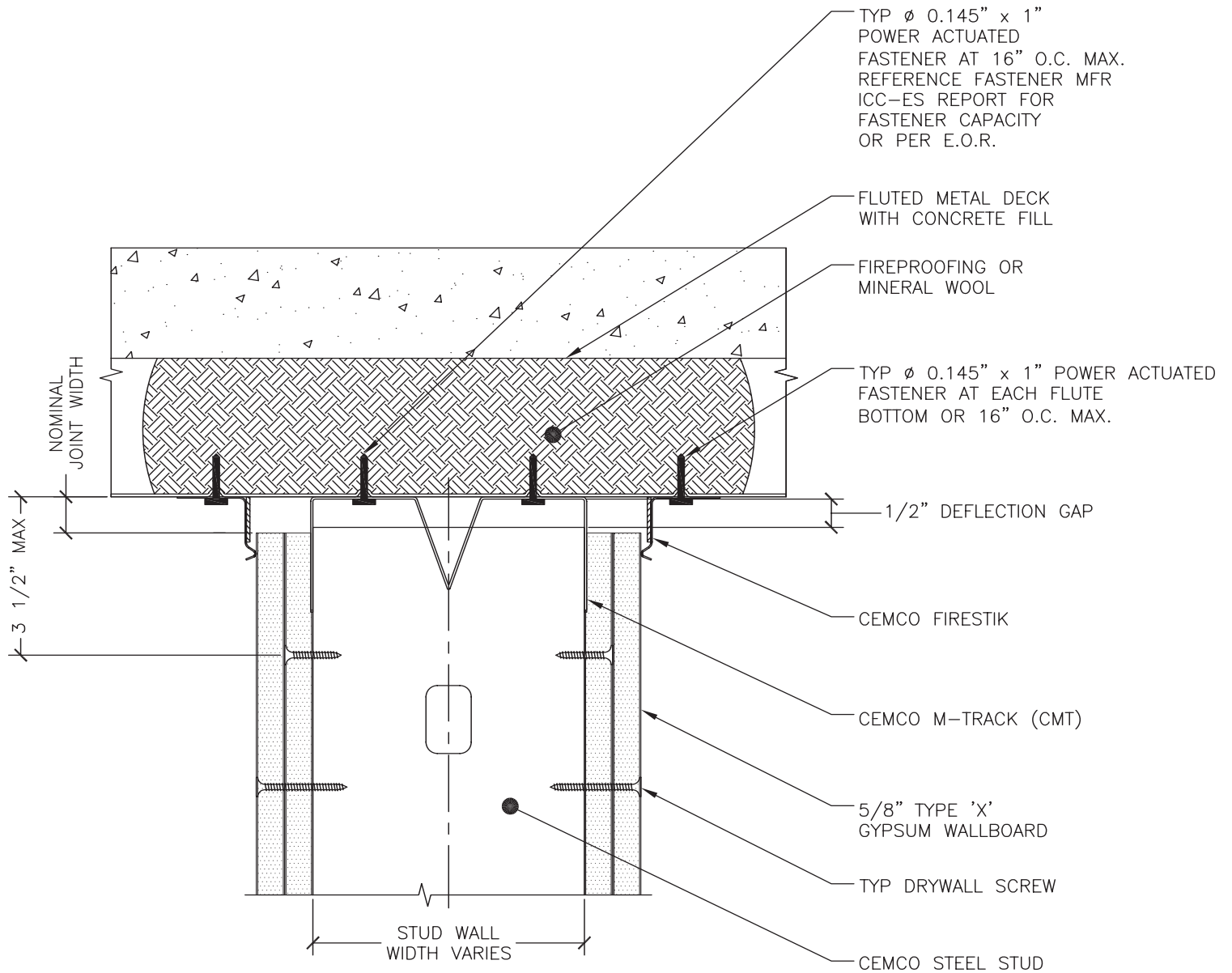

Head of Wall System 1, perpendicular to flute detail  
with  $\pm 1/2$  inch allowable vertical movement  
2 hour fire resistive assembly

S1	PL
MF	2

UL 2079 Test STD.



## Notes

- Cyclical Design — UL 2079 Test Standard
- Do not screw drywall or stud to M-Track
- Reference ITS/Warnock Hersey Directory for specific information
- Reference UL Fire Resistance Directory for specific information
- Made in America

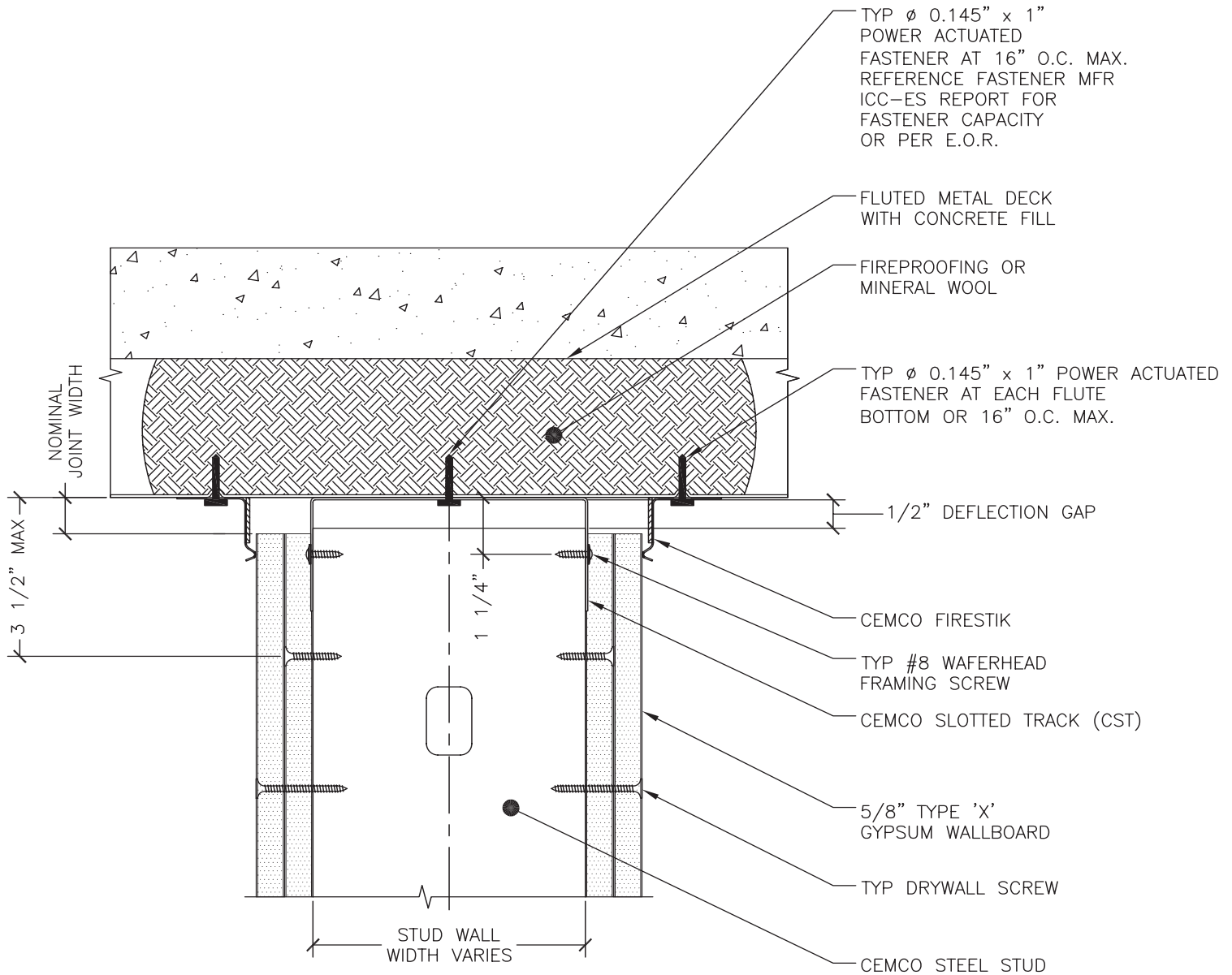

Head of Wall System 1, perpendicular to flute detail  
 with  $\pm$  1/2 inch allowable vertical movement  
 2 hour fire resistive assembly

S1	PL
SF	2

UL 2079 Test STD.



## Notes

- Cyclical Design — UL 2079 Test Standard
- Do not screw drywall to Slotted Track
- Reference ITS/Warnock Hersey Directory for specific information
- Reference UL Fire Resistance Directory for specific information
- Made in America



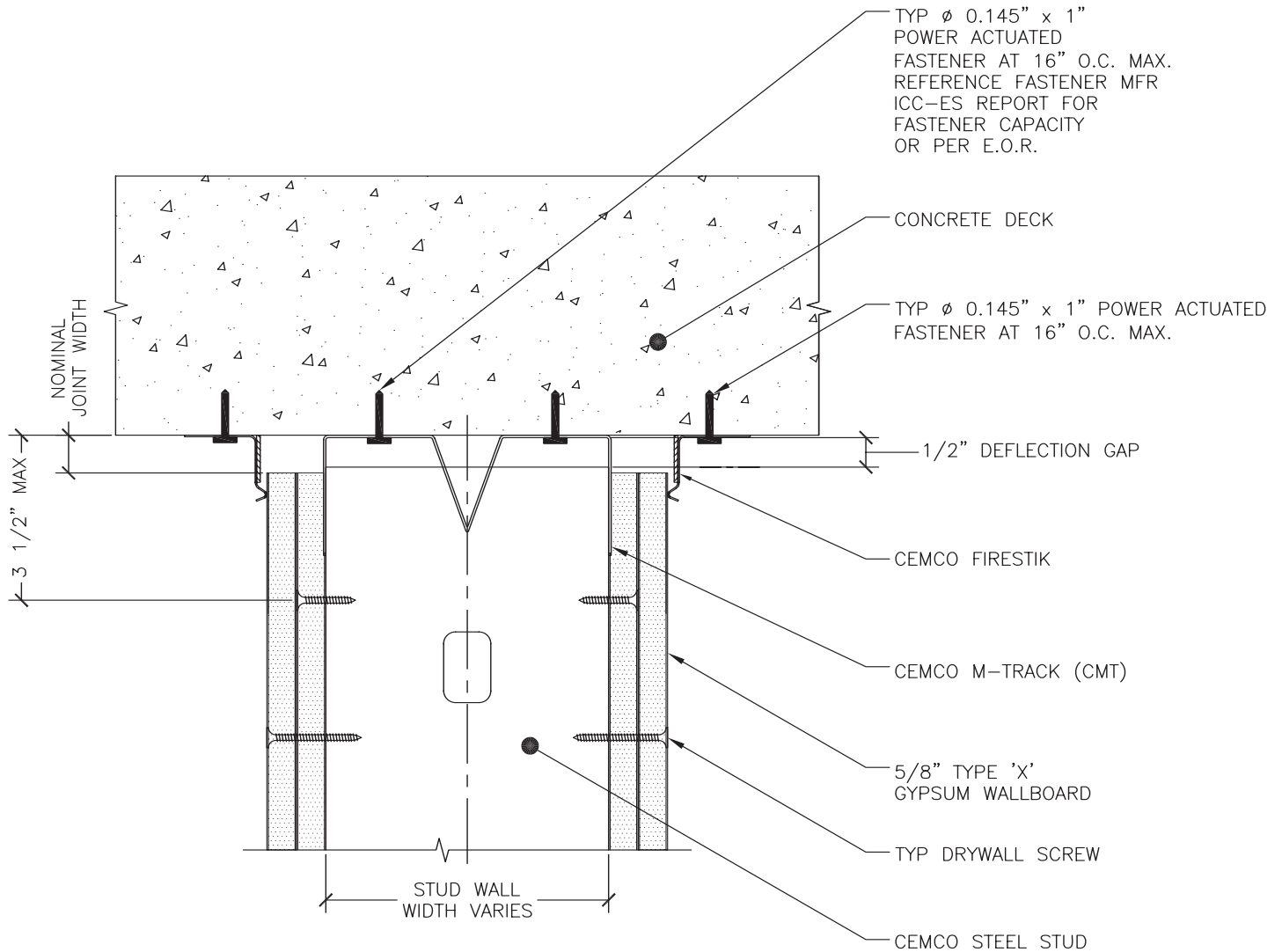

Head of Wall System 2, at concrete deck  
with  $\pm 1/2$  inch allowable vertical movement  
2 hour fire resistive assembly

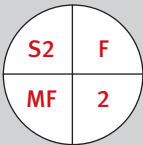

UL 2079 Test STD.



## Notes

- Cyclical Design — UL 2079 Test Standard
- Do not screw drywall or stud to M-Track
- Reference ITS/Warnock Hersey Directory for specific information
- Reference UL Fire Resistance Directory for specific information
- Made in America

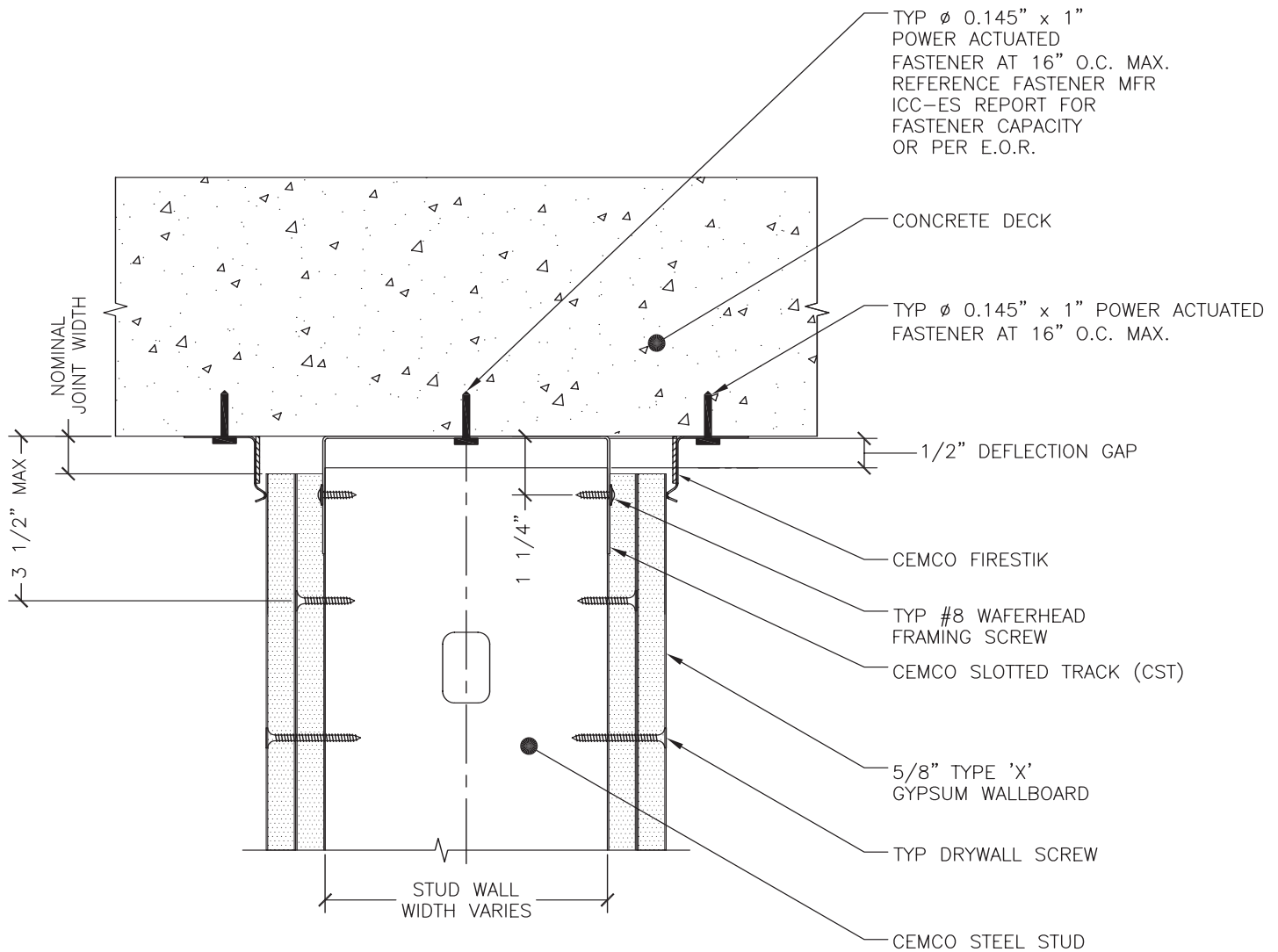

Head of Wall System 2, at concrete deck  
with  $\pm 1/2$  inch allowable vertical movement  
2 hour fire resistive assembly

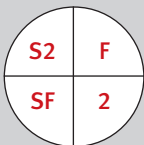

UL 2079 Test STD.



## Notes

- Cyclical Design — UL 2079 Test Standard
- Do not screw drywall to Slotted Track
- Reference ITS/Warnock Hersey Directory for specific information
- Reference UL Fire Resistance Directory for specific information
- Made in America

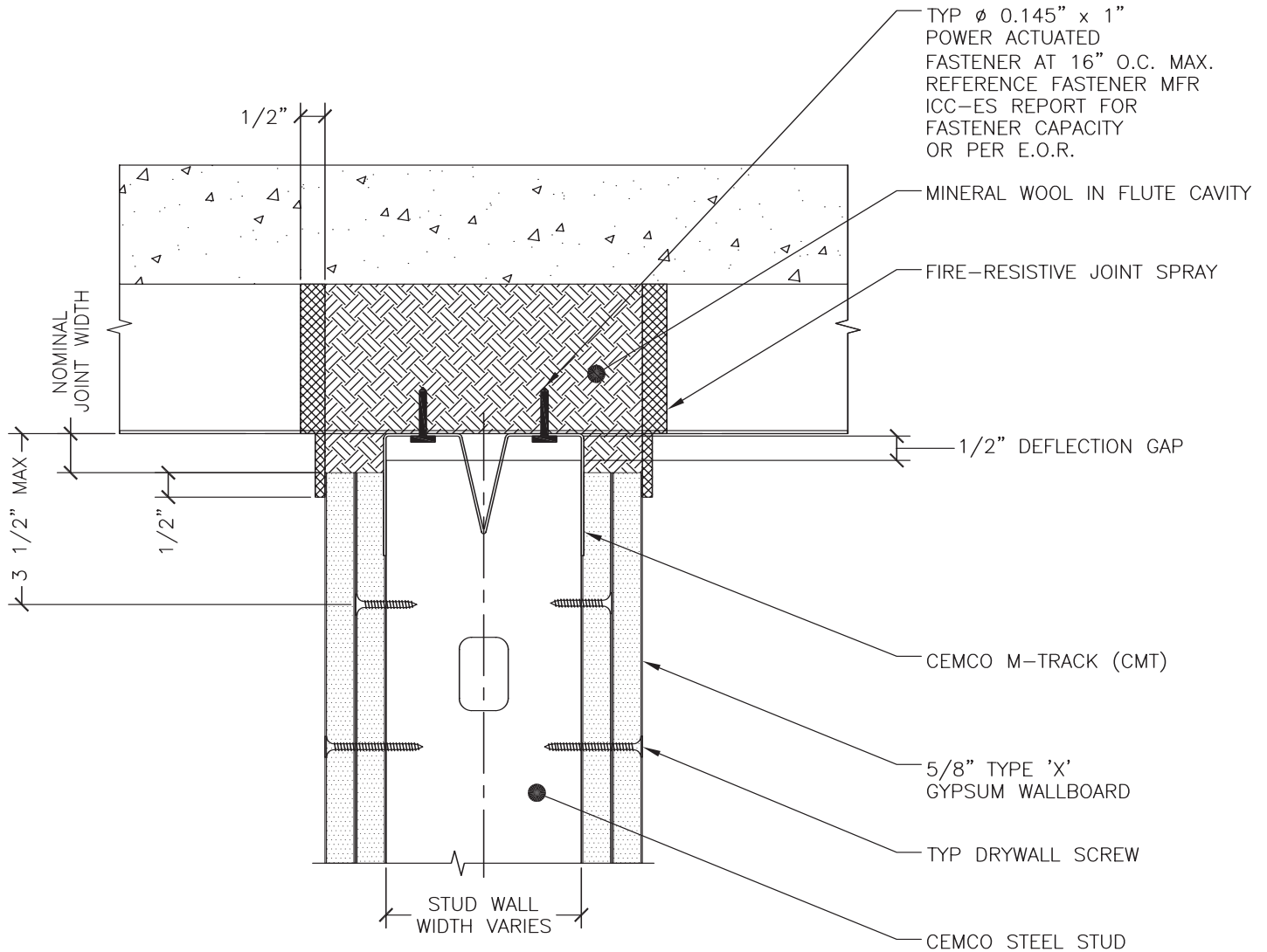

Head of Wall System 3, perpendicular to flute detail  
 with  $\pm 1/2$  inch allowable vertical movement  
 2 hour fire resistive assembly

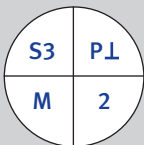

UL 2079 Test STD.



## Notes

- Cyclical Design — UL 2079 Test Standard
- Do not screw drywall or stud to M-Track
- Reference ITS/Warnock Hersey Directory for specific information
- Reference UL Fire Resistance Directory for specific information
- Made in America



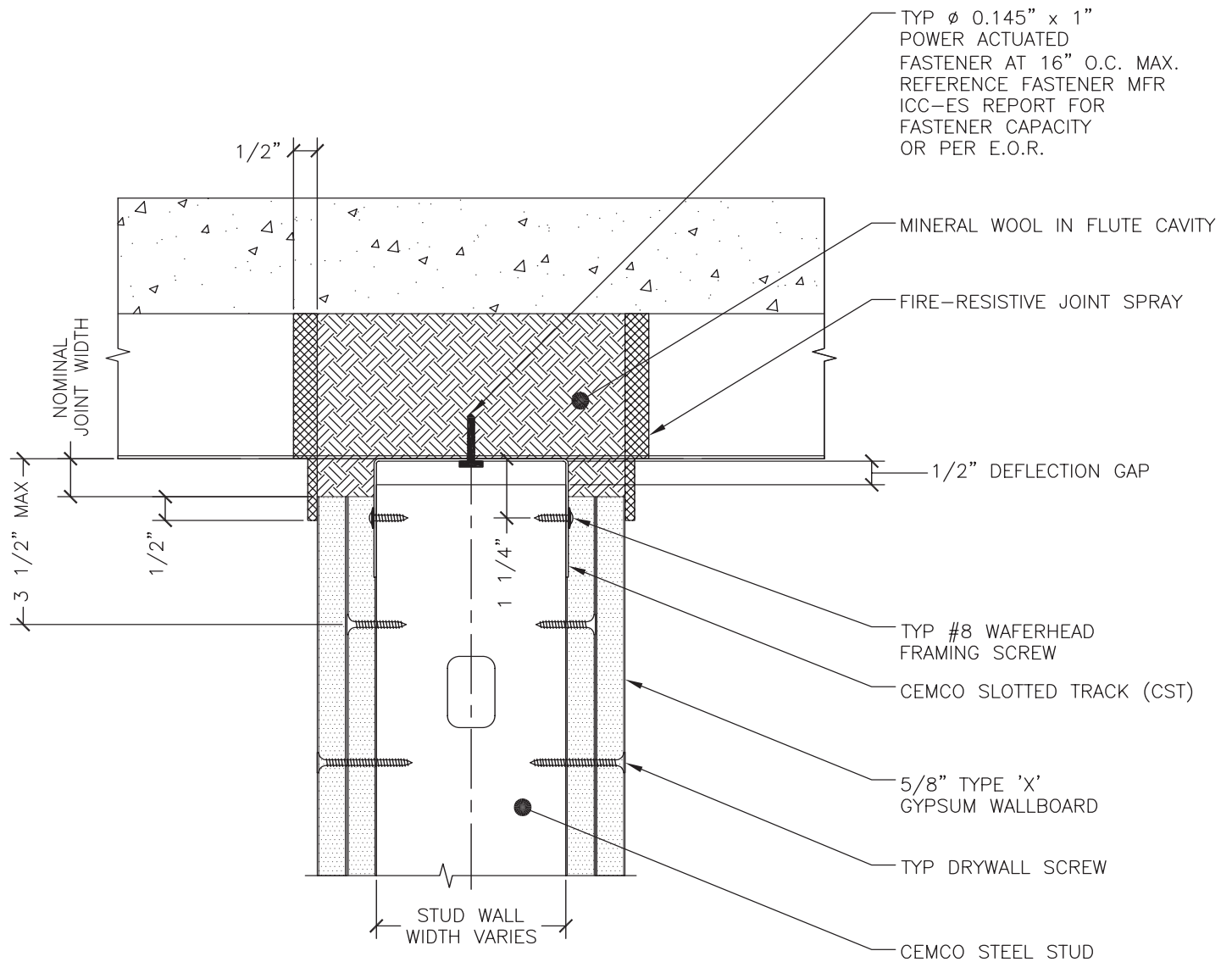

Head of Wall System 3, perpendicular to flute detail  
with  $\pm 1/2$  inch allowable vertical movement  
2 hour fire resistive assembly

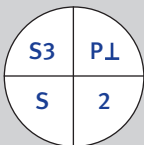

UL 2079 Test STD.



## Notes

- Cyclical Design — UL 2079 Test Standard
- Do not screw drywall to Slotted Track
- Reference ITS/Warnock Hersey Directory for specific information
- Reference UL Fire Resistance Directory for specific information
- Made in America

# FLAT CONCRETE DECK - SYSTEM 4

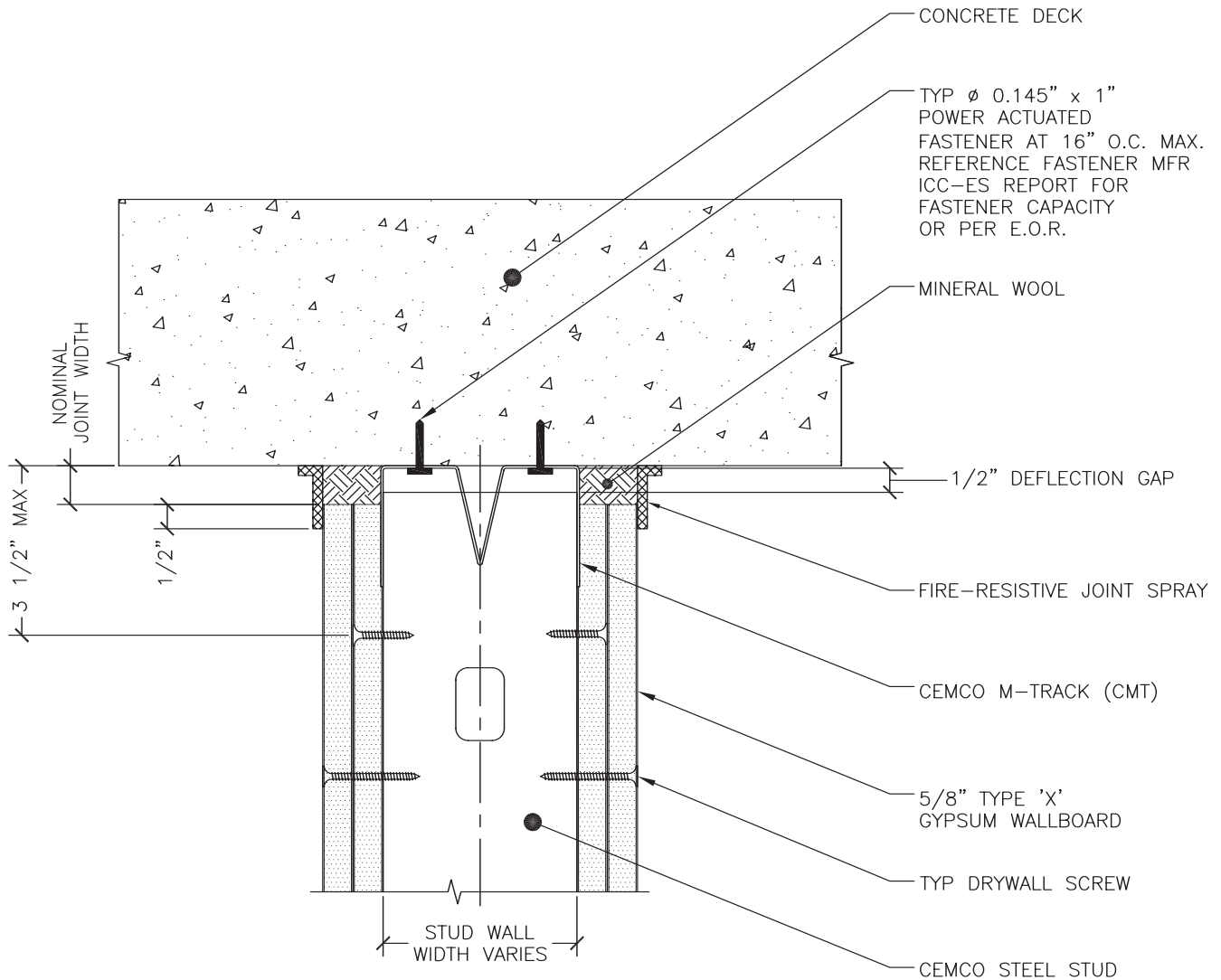

Head of Wall System 4,  
with  $\pm 1/2$  inch allowable vertical movement  
2 hour fire resistive assembly

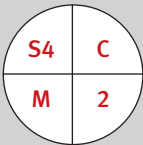

UL 2079 Test STD.



## Notes

- Cyclical Design — UL 2079 Test Standard
- Do not screw drywall or stud to M-Track
- Reference ITS/Warnock Hersey Directory for specific information
- Reference UL Fire Resistance Directory for specific information
- Made in America

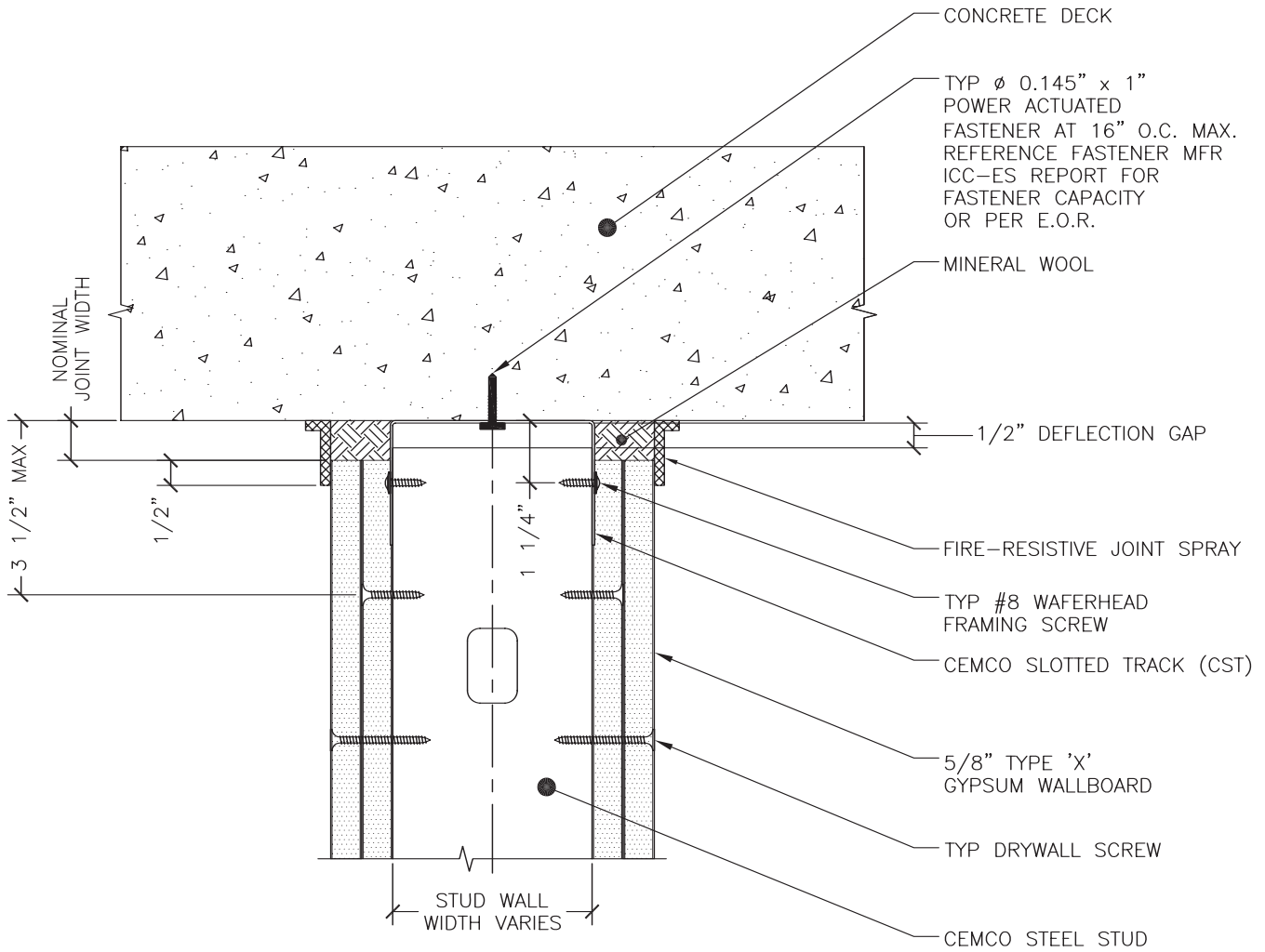

**Head of Wall System 4,  
with  $\pm$  1/2 inch allowable vertical movement  
2 hour fire resistive assembly**

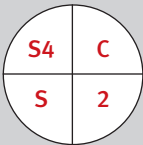

UL 2079 Test STD.



## Notes

- Cyclical Design — UL 2079 Test Standard
- Do not screw drywall to Slotted Track
- Reference ITS/Warnock Hersey Directory for specific information
- Reference UL Fire Resistance Directory for specific information
- Made in America

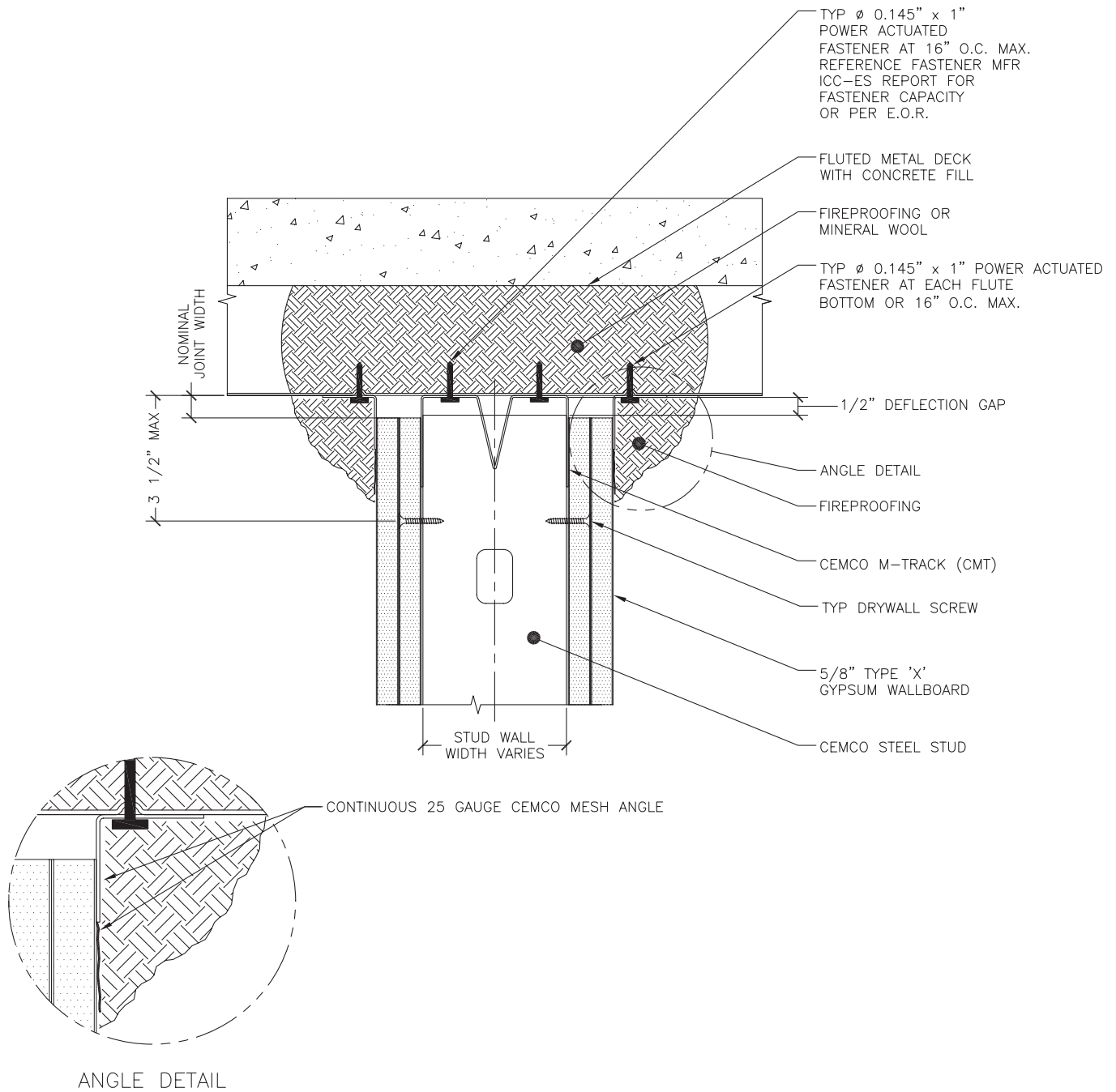

Head of Wall System 5, perpendicular to flute detail  
with  $\pm 1/2$  inch allowable vertical movement  
2 hour fire resistive assembly

S5	PL
M	2

UL 2079 Test STD.



## Notes

- Cyclical Design — UL 2079 Test Standard
- Do not screw drywall or stud to M-Track
- Reference ITS/Warnock Hersey Directory for specific information
- Reference UL Fire Resistance Directory for specific information
- Made in America

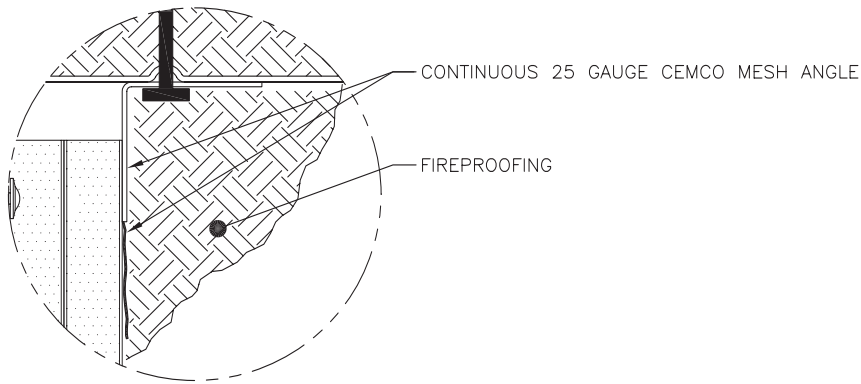
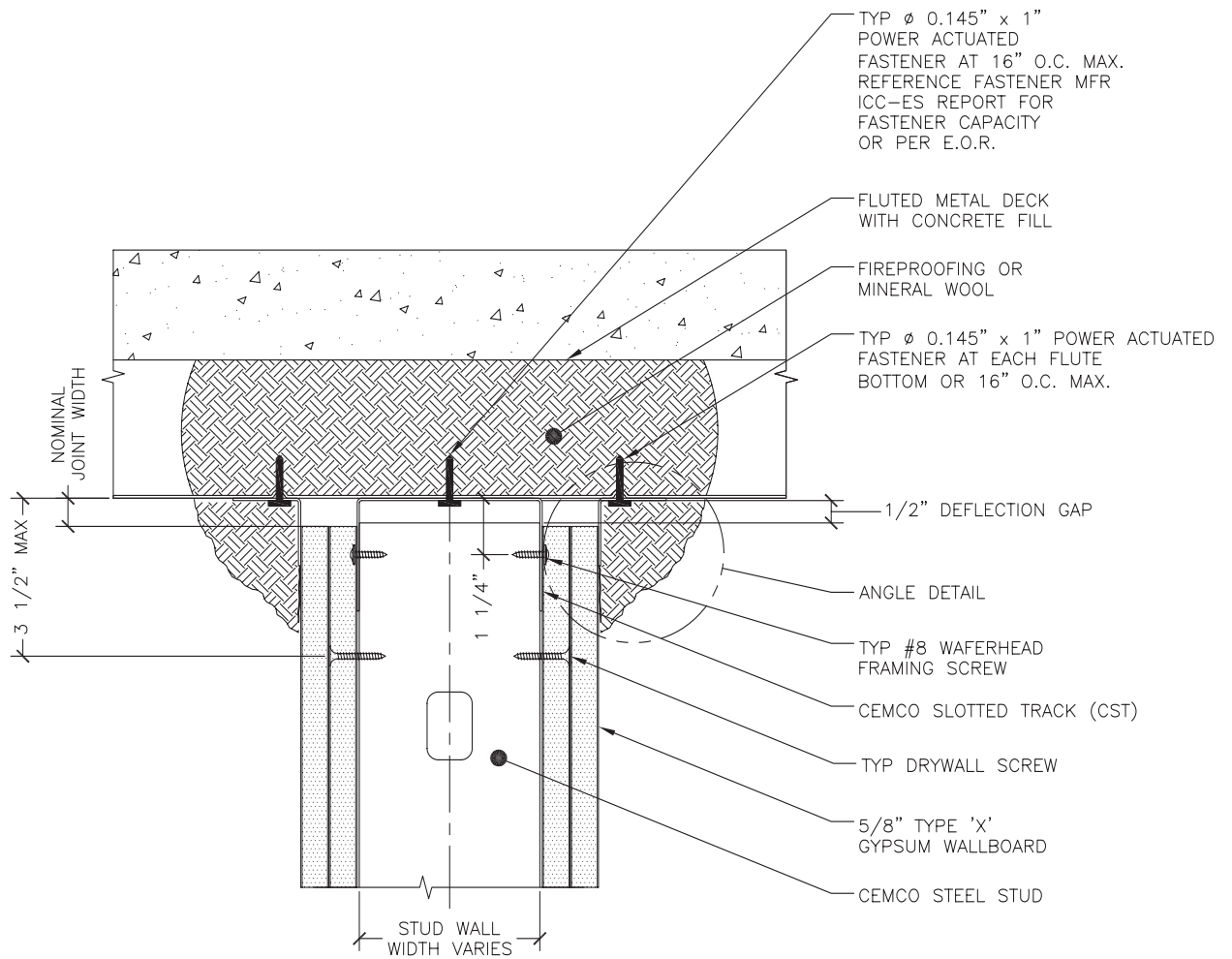

ANGLE DETAIL

Head of Wall System 5, perpendicular to flute detail  
with  $\pm 1/2$  inch allowable vertical movement  
2 hour fire resistive assembly

S5	PL
S	2

UL 2079 Test STD.



## Notes

- Cyclical Design — UL 2079 Test Standard
- Do not screw drywall to Slotted Track
- Reference ITS/Warnock Hersey Directory for specific information
- Reference UL Fire Resistance Directory for specific information
- Made in America



## The Innovators of Quality Framing and Lath Systems

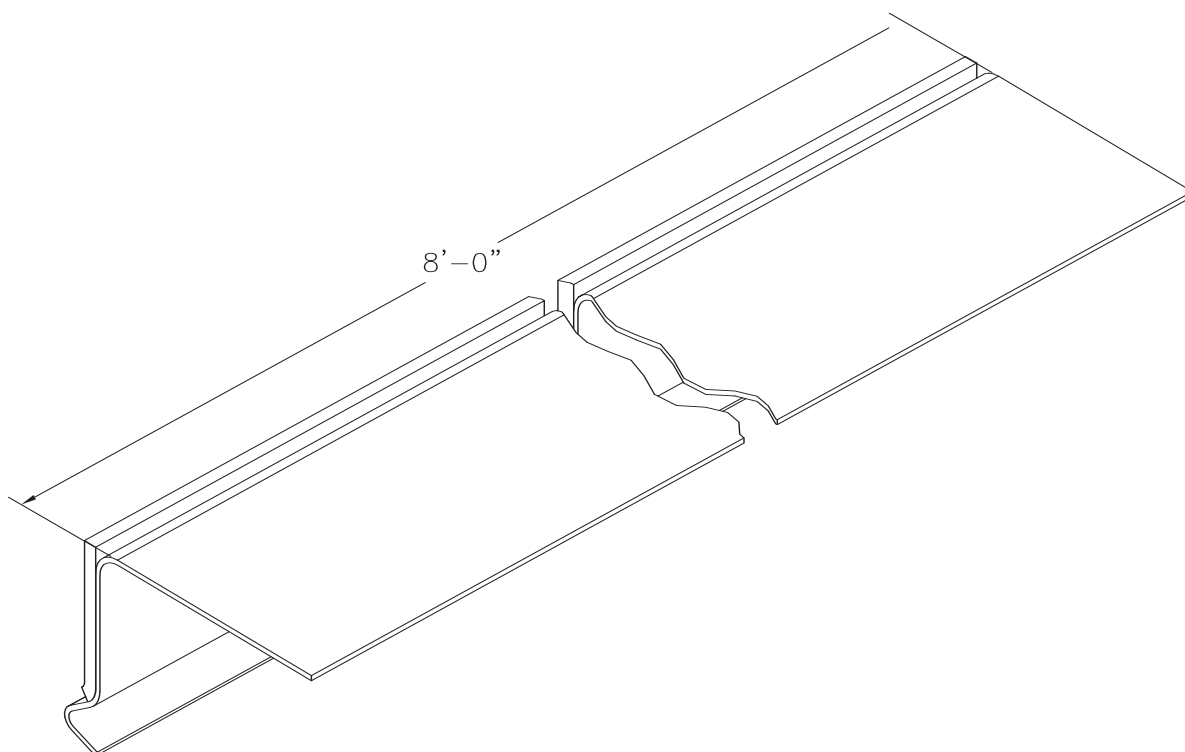

CEMCO FireStik (CFS) continuous angle is used as a fire proofing strip on interior non-bearing head-of-wall assemblies. The continuous L-shaped angle has a 1.5-inch horizontal leg and 1.25-inch vertical leg with a 0.25-inch rib hook at the end. The FireStik is available in 8 foot lengths. An intumescent material .079-inch thick by 1-inch wide strip is adhered to the vertical leg. The FireStik angle member is fabricated from 20 gauge (30 mil) hot-dipped galvanized steel. The FireStik has been tested in accordance with UL 2079 for use in head-of-wall conditions for fire-resistive assemblies listed under the code, UL, and WHI/Intertek.

### CALIFORNIA EXPANDED METAL LATH PRODUCTS CO.

#### Corporate Headquarters & Main Manufacturing Facility

263 North Covina Lane  
City of Industry, CA 91744

Phone: 800.775.2362  
Fax: 626.330.7598

#### Northern California Manufacturing Facility

1001-A Pittsburg Antioch Hwy  
Pittsburg, CA 94565

Phone: 925.473.9340  
Fax: 925.473.9341

#### Denver Colorado Manufacturing Facility

490 Osage Street  
Denver, CO 80204

Phone: 303.572.3626  
Fax: 303.572.3627





- 100% unencumbered movement capability (1" overall)
- No fatigue to the fire-stopping system for the life of the assembly
- Has been tested in accordance with and found to outperform the cyclical, fire, and hose stream tests required in ASTM E-119, ASTM E-814, ASTM 1966, and UL2079
- Labeled for ease of identification
- Effective immediately upon installation with no cure time
- Metal profile eliminates tears, cracks, or material displacement resulting from contact or life cycle
- Eliminate the possibility of "too little" coverage upon application
- Surface clean of dirt, oil, water, and frost is eliminated with no surface adhesion required
- Positively secured with mechanical or friction fit fasteners
- Metal design holds intumescent "in place" until and during expansion from heat or flame
- Eliminate the need for caulk/spray, drywall rips, cutouts, flute plates, and custom track profiles
- Performance is the same with "solid or slotted" leg *head of wall* track
- Allows for horizontal movement
- One profile works in both 1 and 2 hour assemblies
- CEMCO UL listings provide for the use of all UL listed brands of track, fire-proofing, mineral wool, caulks, and sprays
- Patent pending

For more information please contact CEMCO

**(800) 416-2278**

**www.cemcosteel.com**



263 North Covina Lane, City of Industry, CA 91744

(626) 369-3564 ■ (714) 990-6581 ■ fax (626) 330-7598

 **MADE IN AMERICA**

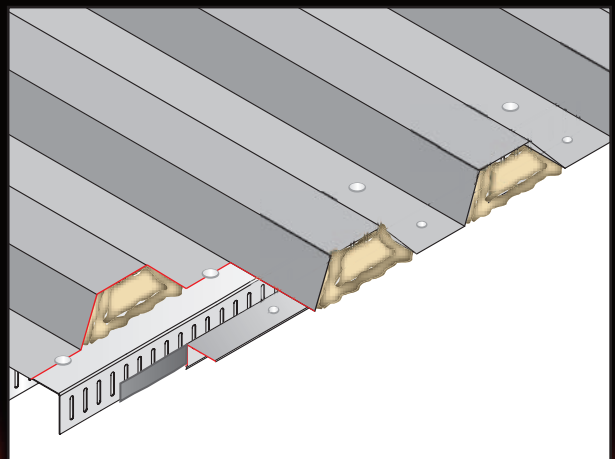
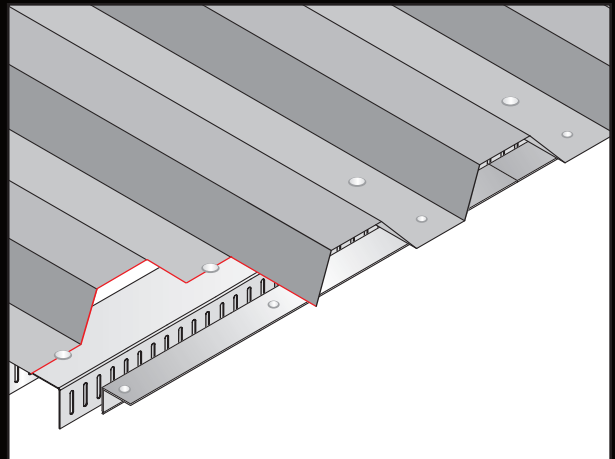
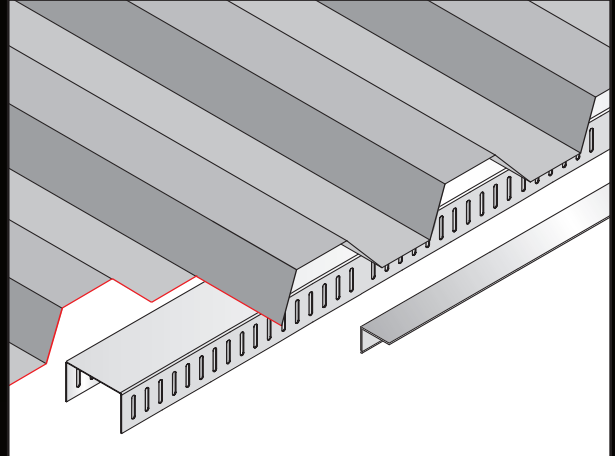



## Labor Savings

- Reduce up to 3/4 of mobilization and high risk “airborne” labor costs to install current fire stop systems
- Install fire stopping material while the top track is being installed
- No MEPs (mechanical, electrical, or plumbing) to work around
- No bottom track, studs, or drywall to work around
- Address both sides of the wall from one position
- Install studs and screw attach (*if necessary*) with **FireStik** already installed
- Install using the same fasteners for track installation
- No labor costs to install drywall rips, cutouts, flute plates or custom track profiles
- One time application no rework
- No adhesion required eliminating the need for a dirt, oil, and water free surface

## Accurate Material Estimation and Cost

- No overspray or unnecessary caulk waste or build up
- No additional machinery (*pump, hoses, or caulk guns*) required
- Eliminates the cost of caulk/sprays, drywall rips, cutouts, flute plates, and custom track profiles
- One profile works for one and two hour assemblies
- 3 feet of **FireStik** will provide exactly 3 feet of coverage

## Ease of Use

- Comes in 8' lengths weighing 2½ lbs per “stick”
- .030 metal cuts easily with a standard snips
- Spacer clamp will jig into place for hands free attachment
- Cemco listings allow for the use of any UL/WH listed track, fire-proofing, caulks, sprays, and mineral wool in the assembly
- Submittal sheets available on disc, website, or printed material
- **FireStik** holds top of drywall during installation
- Attachment is shot/pin at the ends and every 24” between
- No additional fire-stopping needed for TI drywall replacement

For more information please contact CEMCO

**(800) 416-2278**

**www.cemcosteel.com**



263 North Covina Lane, City of Industry, CA 91744  
(626) 369-3564 ■ (714) 990-6581 ■ fax (626) 330-7598

 **MADE IN AMERICA**

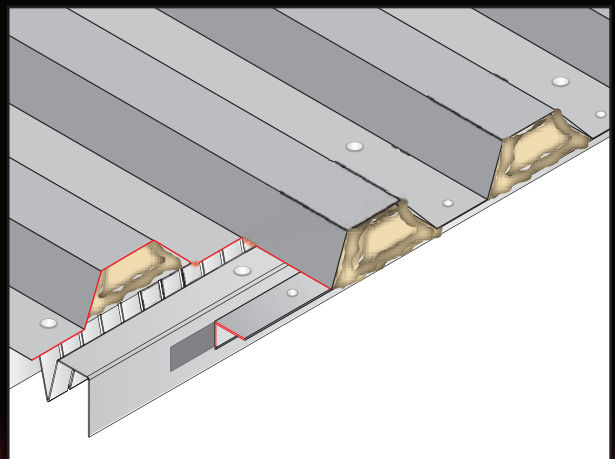
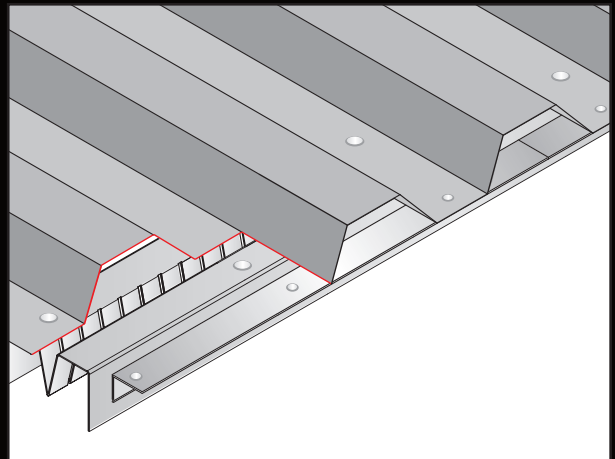
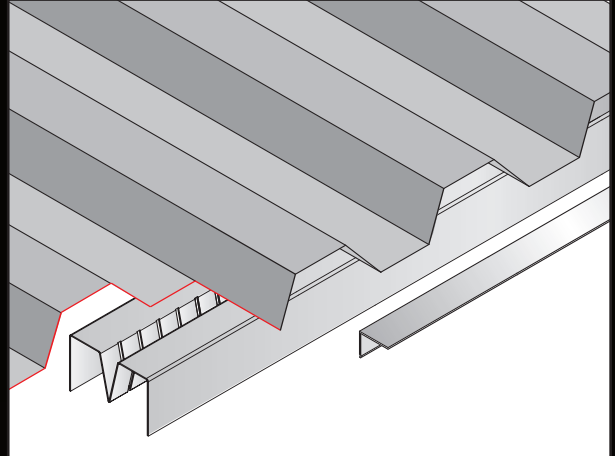



## Slotted Track | CST

- One-piece design
- Saves Material Costs
- Positive attachment to framing
- Absorbs vertical deflection
- Protects the Integrity of Interior and Exterior Walls
- Absorbs Building Movement
- Higher performance with lighter gauge steel
- Simple Installation and Reduced Labor Time
- Provides Easy Code Compliance
- Easy Inspection Approvals
- Variety of Fire Rated Designs
- Offers over 150 UL and ICBO Approved Designs

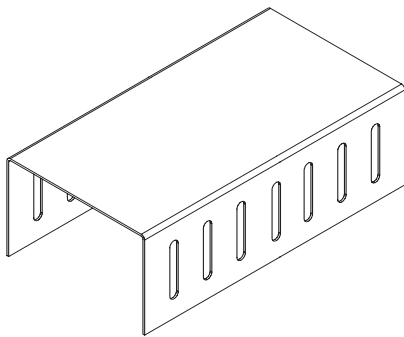

For more information please contact CEMCO

**(800) 416-2278**  
**[www.cemcosteel.com](http://www.cemcosteel.com)**



263 North Covina Lane, City of Industry, CA 91744  
(626) 369-3564 ■ (714) 990-6581 ■ fax (626) 330-7598

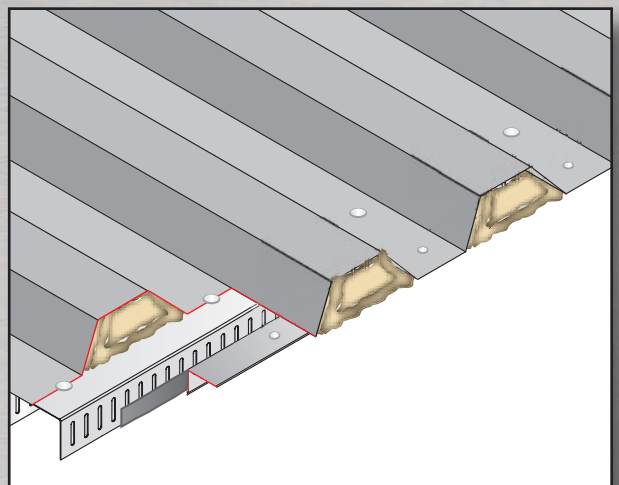
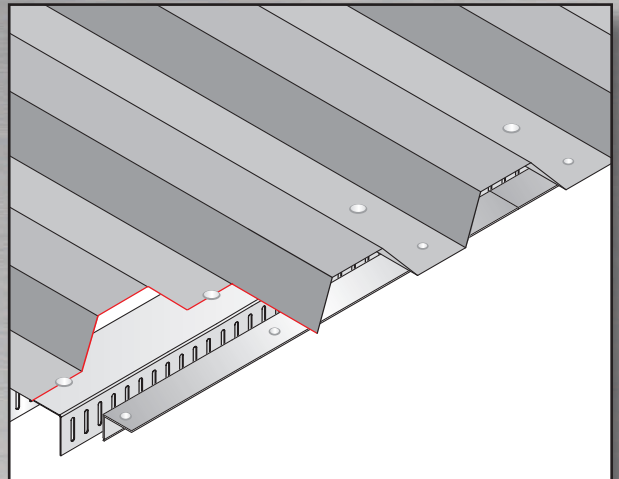
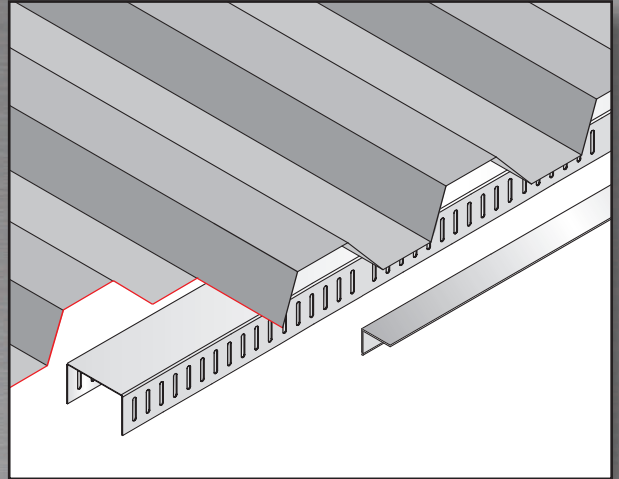

 **MADE IN AMERICA**



## M-Track | CMT

- Eliminates the need for mechanical fasteners to "positively attach" studs
- Interior "V" profile restricts lateral movement of wall framing
- Reduces "high risk airborne labor" required to mechanically attach framing at the HOW
- Avoid system compromise with off center, misplaced, or forgotten fasteners
- Provides for up to 1½" of overall deflection
- Having slots every 1" provides automatic layout for 12, 16, and 24" centers
- Solid leg reduces sound transmission and provides air flow dampening
- Slot layout provides flexibility for both "single and double stud" framing no matter stud flange width
- Patent: 6,748,705

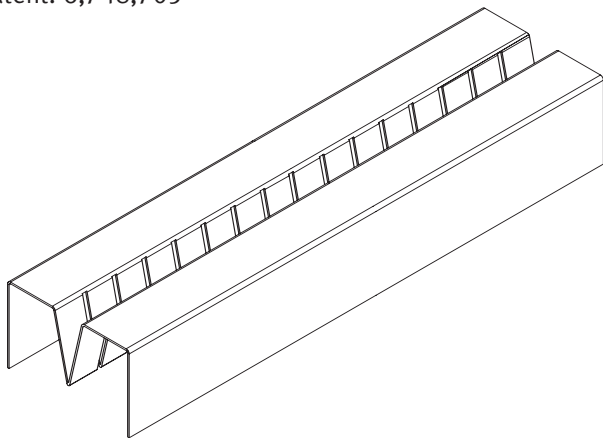

For more information please contact CEMCO

**(800) 416-2278**

**[www.cemcosteel.com](http://www.cemcosteel.com)**



263 North Covina Lane, City of Industry, CA 91744

(626) 369-3564 ■ (714) 990-6581 ■ fax (626) 330-7598

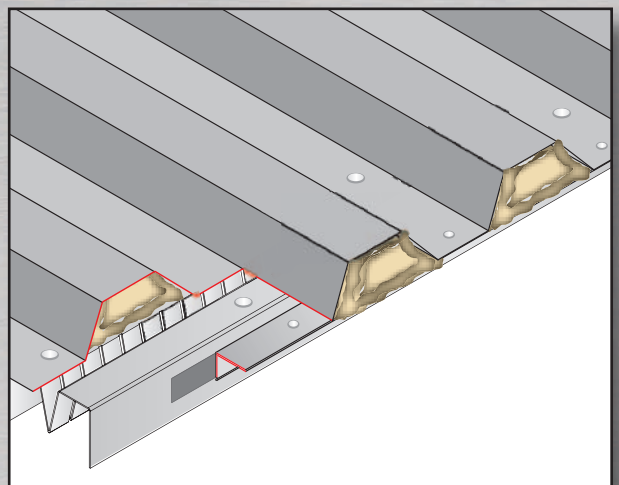
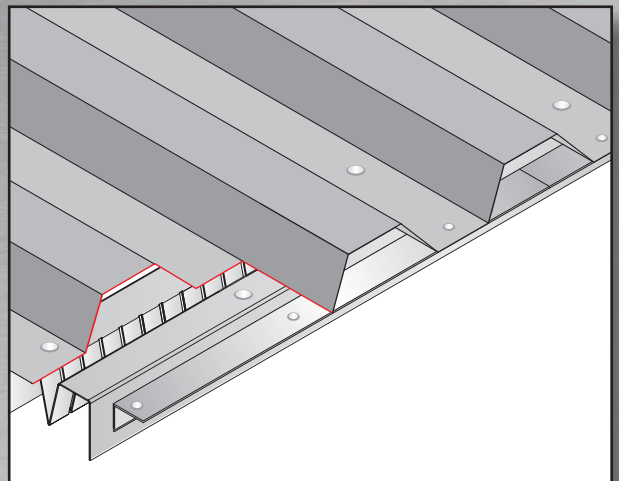
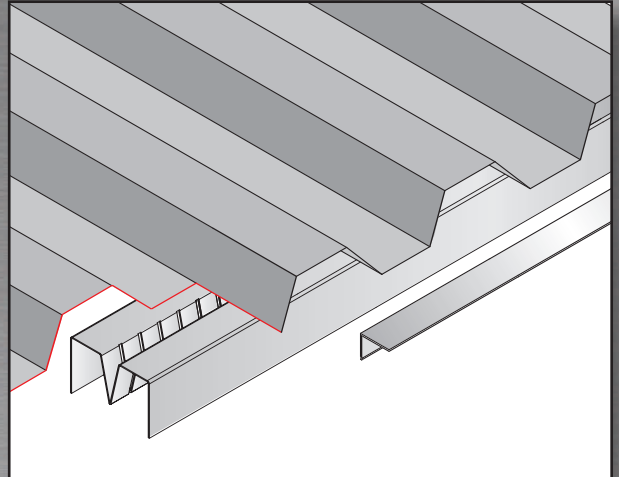

**MADE IN AMERICA**





Slotted Track | CST  
M-Track | CMT

### UL Listings

- **HW-D-0418**  
M-track, FireStik, fluted deck
- **HW-D-0419**  
M-track, FireStik, concrete deck
- **HW-D-0420**  
U-shaped & slotted tracks, FireStik, fluted deck
- **HW-D-0421**  
U-shaped & slotted tracks, FireStik, concrete deck

### Intertek/Warnock Hersey Listings

#### *Wall Assemblies For 1 and 2 hour designs*

- **DESIGN NO. CEM/PV 120-01**  
Slotted or M-Track and FireStik on Concrete Slab
- **DESIGN NO. CEM/PV 120-02**  
Slotted or M-Track and FireStik on Fluted Deck
- **DESIGN NO. CEM/PV 120-03**  
Slotted or M-Track with Spray Fire Proofing on Concrete Slab
- **DESIGN NO. CEM/PV 120-04**  
Slotted or M-Track with Spray Fire Proofing on Fluted Deck



ICC-ES — Pending  
OSHPOD — Pending  
LA City — Pending

**800.775.2362**  
**www.cemcosteel.com**

#### Corporate Headquarters & Main Manufacturing Facility

263 North Covina Lane  
City of Industry, CA 91744

Phone: 800.775.2362  
Fax: 626.330.7598

#### Northern California Manufacturing Facility

1001-A Pittsburg Antioch Hwy  
Pittsburg, CA 94565

Phone: 925.473.9340  
Fax: 925.473.9341

#### Denver Colorado Manufacturing Facility

490 Osage Street  
Denver, CO 80204

Phone: 303.572.3626  
Fax: 303.572.3627