

REPLACING 30-MIN TIMER ON 508 SERIES PIZZA OVEN

READ ALL INSTRUCTIONS PRIOR TO BEGINNING ANY WORK ON THE 508 12" PIZZA OVEN.

ITEM	DESCRIPTION	QTY.
1	SHEET METAL SCREW	5
2	BOTTOM PANEL	1
3	SHEET METAL SCREW (DO NOT REMOVE)	1
4	120V POWER CORD	1
5	TIMER KNOB	1
6	TIMER SCREW	2
7	RED WIRE	1
8	RED WIRE	1
9	RED WIRE	1

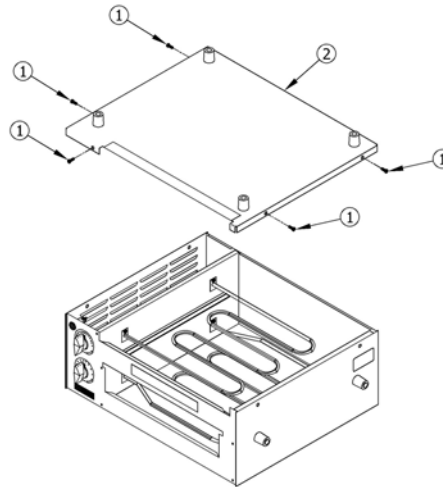

Recommended Tools

- Phillips Head Screwdriver
- Needle-nose Pliers
- Gloves
- Safety Goggles



A risk of fire and electrical shock exists in all electrical appliances and may cause personal injury or death. Please follow all instructions carefully and verify that your oven is disconnected from power source and has cooled completely.



This procedure should be performed by qualified maintenance personnel with experience repairing electrical, or electro-mechanical equipment. If you have any questions regarding this procedure, contact your Sales Representative or Dealer.

Before You Begin

- Disconnect oven from power source.
- Allow oven to cool completely before performing any maintenance.
- Remove food from oven.
- Remove oven from food preparation, cooking, or food storage area.
- Remove the crumb tray, food rack, and food rack cover from oven and place the components in a safe location.
- Retain all fasteners removed from the oven for later reassembly.

Disassembling The Oven.

1. Turn the oven upside down.

2. Remove the oven's bottom panel (2) by removing five sheet metal screws (1). One screw is located below the front panel and the other four are found in pairs on opposite sides of the oven. **DO NOT** remove the sheet metal screw (3) from the back of the oven, located near the 120V power cord (4). When removing the bottom panel (2), make note of its orientation, as reinstallation of the panel is the reverse.
3. Remove the timer knob (5) from the timer shaft and retain it for use in reassembly.
4. Remove the two timer screws (6).
5. Disconnect the red wires (7 and 8) from the male switch terminals. When removing the red wires, only apply force to the female terminal located at the end of each wire. Also, when disconnecting the wire (7) from the timer's left terminal, ensure that you **DO NOT** detach the wire (9) that connects to either the red power-on light or the temperature control, both located below the timer.
6. Discard the defective timer.

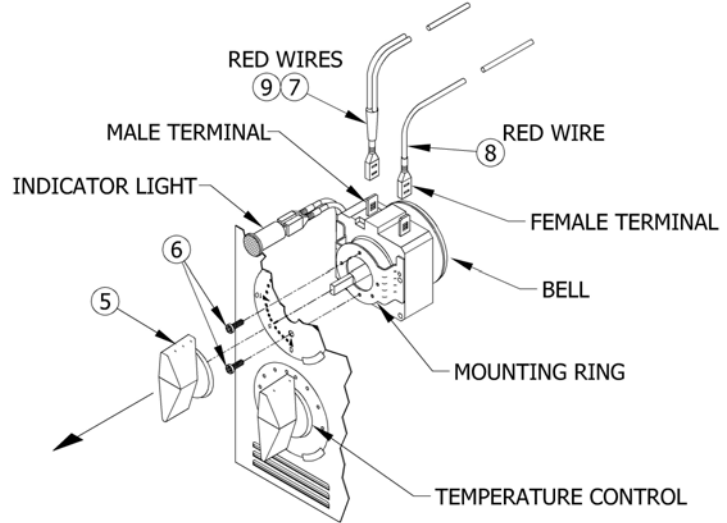

Installing the New Timer and Oven Reassembly

7. Orient the new timer so that the male switch terminals face upward.
8. Reconnect the red wires (7 and 8) to the new timer's two male switch terminals, ensuring that the wires are attached to the proper terminals as observed in the above diagram. Verify that the wires are securely fastened to the terminals.
9. Orient the timer within the oven so that the connected red wires face upward and the mounting ring makes contact with the inner oven wall. Align the holes on the timer's mounting ring with the holes on the front panel.
10. Fasten the timer to the inside of the oven wall by using the two timer screws (6) removed in Step 4.
11. Securely attach the timer knob (5) to the timer shaft. Ensure that the pointed end of the timer knob faces the "0" minute mark on the front panel.
12. Reinstall the bottom panel (2), ensuring that the back side of the bottom panel is tucked under the ledge on the oven's back wall. Secure the bottom panel (2) by using the five sheet metal screws (1) removed from the oven in Step 2.
13. Turn the oven over and replace the crumb tray, food rack, and food rack cover.
14. Plug power cord into a 120V AC outlet. Rotate timer knob (5) and check for heat-up to verify proper operation.

